

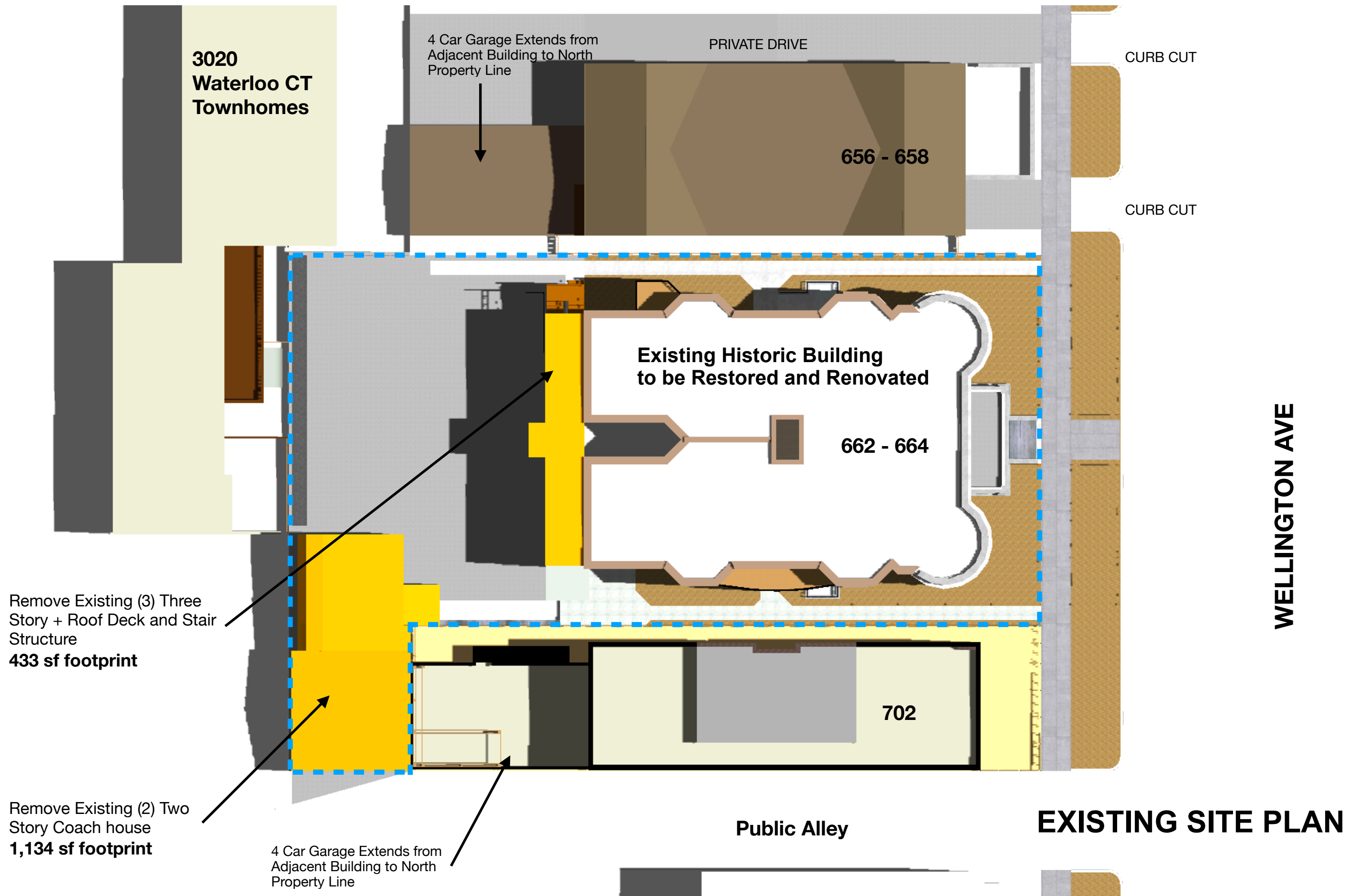

662-664 West Wellington Ave
Lakeview Historic District

Existing Historic Building to be Restored and Renovated

662-664 W Wellington



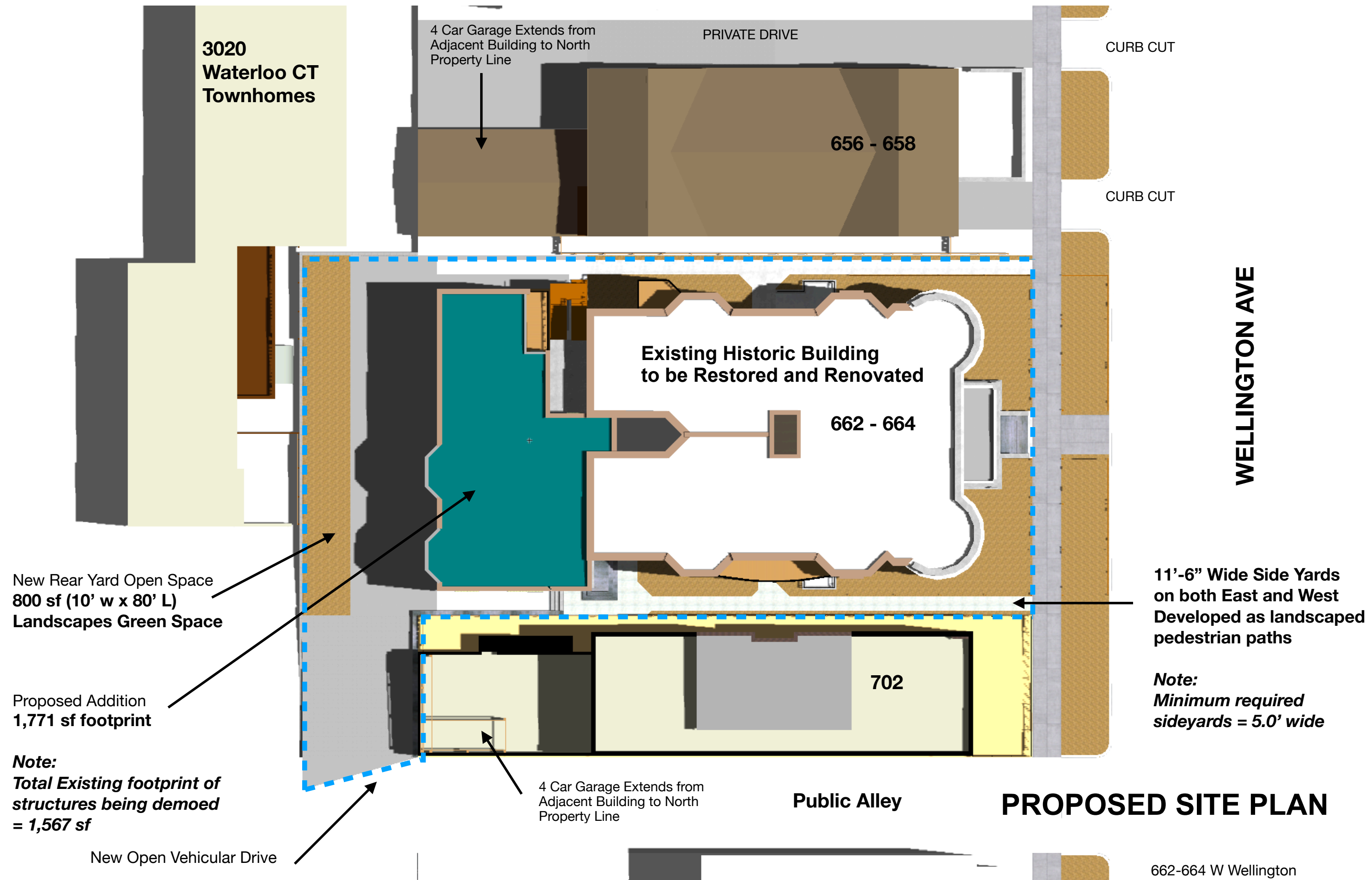







New Masonry
Addition at Rear

Adjacent Townhome
Patios - 4' Below Grade

New Rear Yard Open Space
800 sf (10' w x 80' L)
Landscapes Green Space

New Open
Vehicular Drive