

N. SOUTHPORT AVE
TWO-WAY TRAFFIC

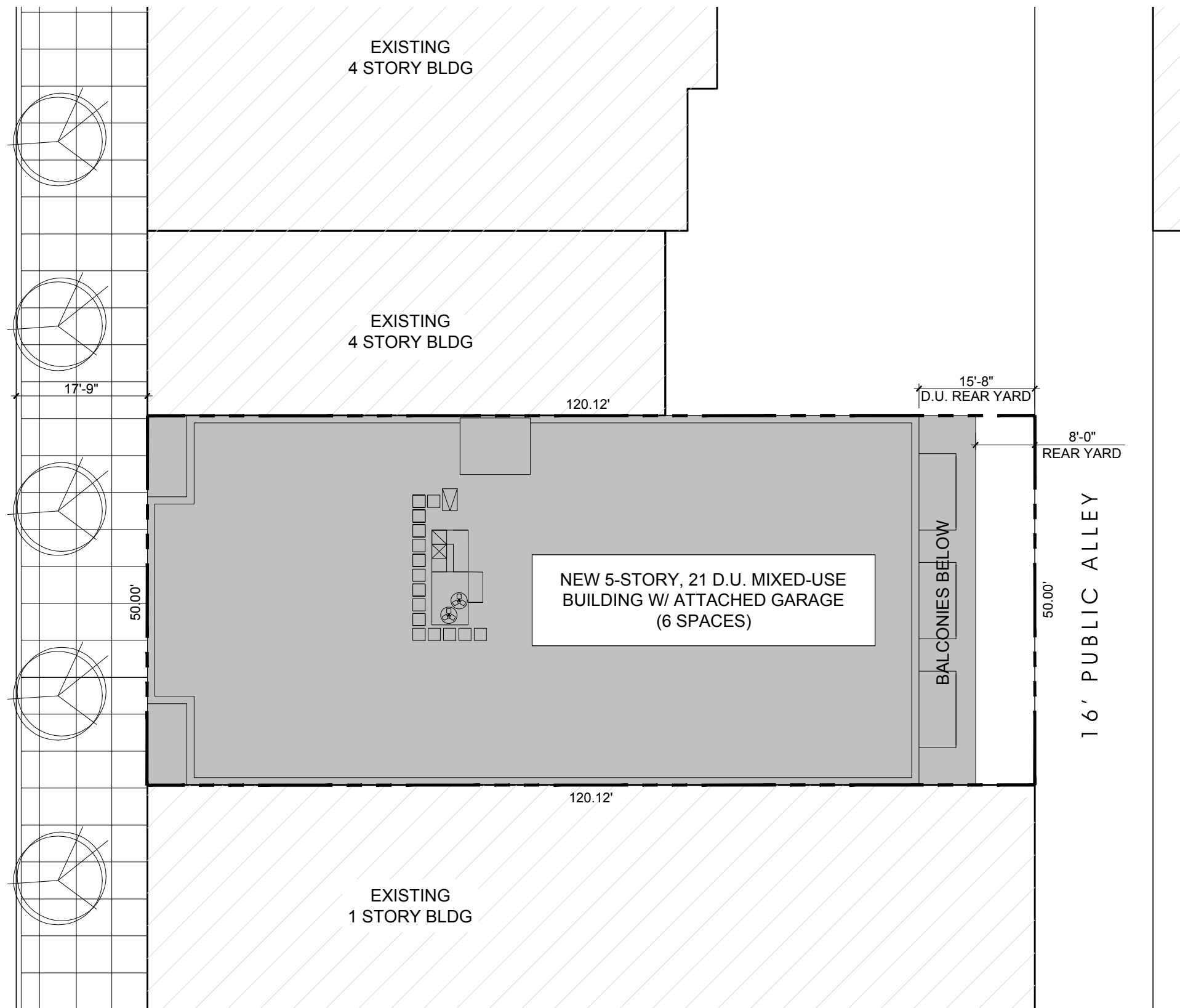

ZONING DATA	
SITE AREA	6,006 SF
ZONING	B3-3 TOD
FAR	4.0
MAX FAR SF	24,024 SF
MLA	300/200 SF
MAX UNIT COUNT	21

PROJECT DATA - FIVE STORY SCHEME	
PARKING PROVIDED (TENANT):	5
PARKING RATIO:	.29/1
CAR SHARE PARKING:	1
BIKE PARKING:	42
NET RETAIL:	2,470 SF

BASEMENT GROSS:	1,940 SF
FIRST FLOOR GROSS:	5,557 SF
SECOND-FIFTH FLOOR GROSS:	
4 @ 5,099 SF =	20,396 SF
TOTAL GROSS SF:	27,893 SF

FIRST FLOOR FAR:	3,616 SF
SECOND-FIFTH FLOOR FAR:	
4 @ 5,099 SF =	20,396 SF
TOTAL FAR SF:	24,012 SF

EFFICIENCIES -	
1 @ 578 SF:	578 SF
1 @ 652 SF:	652 SF
1 @ 660 SF:	660 SF
ONE BEDS -	
4 @ 782 SF:	3,128 SF
4 @ 802 SF:	3,208 SF
4 @ 876 SF:	3,504 SF
3 @ 926 SF:	2,778 SF
3 @ 962 SF:	2,886 SF
TOTAL NET RESIDENTIAL RENTABLE:	17,394 SF

TOTAL UNITS:	21
AVERAGE UNIT SIZE:	828 SF

